



[www.madeicentro.pt](http://www.madeicentro.pt)  
[www.golden-parquet.pt](http://www.golden-parquet.pt)



**GOLDEN®  
PARQUET**



Finished Product Department

Edifício Madeicentro  
EN1/IC 2  
Apartado 5  
3781-901 Avelãs de Caminho  
Tel. +351 234 730 700  
Fax +351 234 730 701  
Email: [madeicentro@madeicentro.pt](mailto:madeicentro@madeicentro.pt)  
[info@golden-parquet.pt](mailto:info@golden-parquet.pt)

## GENERAL TERMS. STORAGE AND INSTALLATION. - MULTI-LAYER PARQUET -

### GENERAL TERMS

**MULTI-LAYER** parquet is a masterpiece of engineering which allows the rationalisation of wood (by reducing the environmental impact) while diminishing variations due to exposure to moisture.

The floor is a construction element which is strongly subject to loads of various natures, exposed to environmental conditions and aggressive products which require adequate response. The **MULTI-LAYER** parquet is a tangible demonstration of these concepts. On one hand, the conception of a resistant structure composed of a lower layer (plywood), on the other hand, the aesthetic beauty of the hardwood on the top layer, allied to the production finishing with high resistance UV varnish.

This is aesthetically attractive and contributes to sophisticated, cosy, joyful and relaxed environments. As a natural material it is also very resistant, durable, anti-allergic, nice and versatile.

It is purposed for installation indoors and does not possess the ability to support loads for which the laying basis must be solid and stable.

Should its installation be intended for radiant flooring, additional instructions are to be considered.

It is produced in conformity with the corresponding Product Standard and a rigorous Quality Control. It requires a careful installation and maintenance for which it is crucial that the rules hereon described are respected.

### 1. PARTICULARITIES OF WOOD

Wood is a natural product which holds particular characteristics, varying in colour and texture, streaked darker, small closed knots, etc. Thus a choice prior to installation so as to combine the various tones in different rooms, if it is so intended, is recommended.

### 2. STORAGE AND HYDROMETRIC CONDITIONS AT THE PLACE OF INSTALLATION

Our **MULTI-LAYER** parquets are supplied with an average moisture ranging  $7 \pm 2\%$ , which must be stored in a dry and ventilated place, never in a humid site, until the date of installation. The Multi-layer should be left for 48 hours where it shall be installed, in the original packaging and on a horizontal position.

The openings to the building must be duly closed so as to avoid damage caused by the entrance of dirt, water, excessive moisture and direct sunlight. It is advisable that all windows exposed to sunlight are covered with paper or blinds, if possible.

The installation must be performed at a minimum temperature of 15°C and a maximum of 22°C. The relative moisture should not be inferior to 40% nor superior to 60%.

### 3. ADVICE / INSTALLATION CONDITIONS

The installation of the multi-layer parquet must be performed by a professional. The choice of a professional worker is the best guarantee for a good installation.

#### 3.1. FLOOR FOUNDATION

- » The cement screed must be clean, dry and regular. The screed requires a minimum drying time of 60 days;
- » The thickness of the screed must be superior to 4 cm;
- » The screed must be sufficiently hard and rigid to support the traction force induced by glue;
- » The surface must be clean and clear of elements which may offer obstruction to the installation;
- » The screed must have the necessary height, at least in relation to the doorsill, to allow a correct laying.
- » For all cement floors in which the inclusion of Leca isolation against moisture is imperative (Leca absorbs and retains moisture coming from the mortar, which transfers to the parquet).
- » Should it be necessary to apply isolation, hardening, repair paste or other products on the screed it is necessary to obtain information from the installation professional as to the reference of the glue to be used on the parquet before purchasing so as to foresee the use of compatible products → incompatibility between products shall cause the non-gluing of the parquet to the substrate. Request technical support from the supplier(s).
- » The residual moisture of the screed must be inferior to 2.5%.

**3.2. INSTALLATION**

» This parquet may be directly glued to the floor foundation or fitted dispensing a fixing device (floating device). So as to obtain greater stability gluing is recommended.

» In order to allow regular wood expansion/retraction (variable according to the specie can change  $\pm 1\%$  on the width and  $\pm 0,3\%$  on the length) it is essential to ensure a minimum of 10 mm perimeter expansion joint between the parquet and the walls, pillars, heating pipes, stairs or any other fixed element. These joints shall be covered by the skirting, aluminium/PVC profiles, auto-adhesive slats, silicone, etc.

» General rule dictates the elements must be placed lengthways in relation to the dominant sunlight orientation;

» Working from left to right positioning the first element with the groove facing the wall. Use spacers to allow an expansion joint. Proceed with the fitting of the tops of the elements with the use of a wooden or plastic tile and applying a line of glue on the inside of the groove (floating system) – fig. 1

» When trimming the last part must be cut so as to perfectly fit the wall with the aid of a crowbar. The remaining part shall serve for the next row (see fig. 5). Should the wall not be straight the element must be laterally cut in agreement with the profile of the wall;

» The following rows are installed by fitting the tongue in the previous row with the aid of a hammer stroke on a wooden tile (identical to fig. 1 but on the side of the element instead);

» The elements in the last row must be cut lengthways at a width which ensures the expansion joint between the wall and the parquet and adjusted with a crowbar. In case the width is inferior to 5 cm it is necessary to balance the laying by reducing the width of the elements on front row – fig. 3.

» In areas which are longer than 12 m or larger than 8 m a cut on the parquet to open an expansion joint is indispensable (often this situation arises because in bedrooms and corridors there is not an interruption of the parquet which spreads as a single surface). The preferential places to install this type of joint are the beginning of the corridors and the doors.

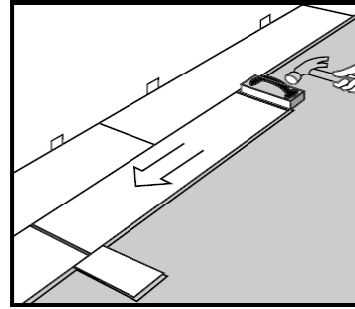

**Fig.1** – Fitting adjustment with a wooden tile and a hammer

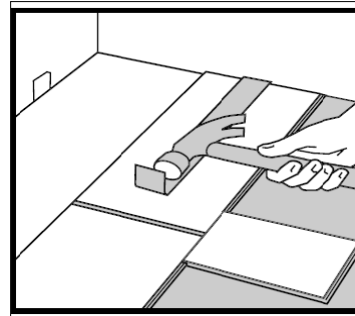

**Fig.2** – Fitting adjustment with a crowbar

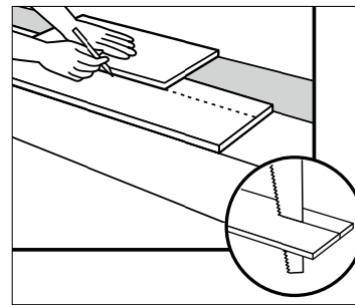

**Fig.3** – Trimming the last part

◀ Calculating the total number of elements per room in order to make the necessary adjustments

**RECOMMENDATIONS:**

» The perimeter gaps (10 mm) are secured by the placing of auxiliary wedges – fig. 4

» Avoid the glue installed on the fitting system to overflow the joint. In case this happens immediately remove it by using a wet cloth.

» Orifices for pipes must have a 20 mm wider diameter than the tubes – fig. 6

» **The support for the frames (doorframes) on the parquet must consider a gap of  $\pm 1$  mm (use a wedge to set the gap).**

» The entire parquet shall be as a single element which moves together. In order to allow the free movement of the fixed elements (frames) glue must not be installed on the fitting parts in this area.

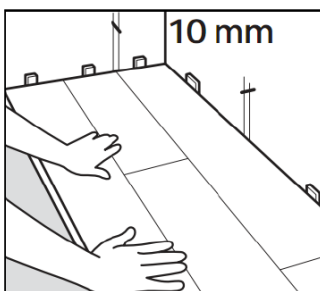

**Fig.4** – Perimeter gap with auxiliary wedges

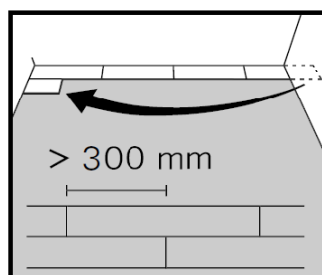

**Fig.5** – Minimum distance between transverse joints

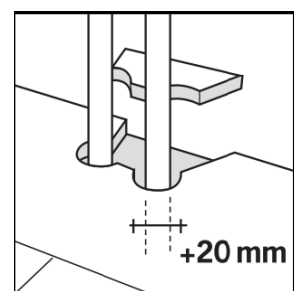

**Fig.6** – Trimming in pipe area

## 4. INSTALLATION ON RADIANT FLOORING

Installation by gluing is the most recommendable in this type of floor. Notwithstanding the floating setting being the most adequate, the thermal inertia of the resilient sheathing may compromise the thermal performance of the system, causing higher energy consumption.

Wood has a lower thermal conductivity than other materials used in floor coating thus the amount of conduction tubes must be 1/3 higher than that used in ceramic coatings.

### GENERAL RECOMMENDATIONS:

- » Do not use on wood that is very sensitive to moisture and do not use on higher density wood for this has greater thermal conductivity;
- » Thermal Resistance of Multi-layer Floorboards must be inferior to 0.15 m<sup>2</sup>K/W ;
- » Use water-free glue or low on water and solvents;
- » 28°C is the maximum recommended temperature in the radiant heating system at the surface of the laying foundation;

### SUPPORT TERMS:

- » The heating system must be activated at an average power (30°C) from two to three weeks and shut-off a day or two before the beginning of the installation. Once the Multi-layer is installed the temperature must suffer a 3 to 5°C increase per day;
- » The minimum thickness of the mortar above the heating piping is 30 mm;
- » The moisture of the screed must be slightly inferior to 2%;
- » The use of levelling, waterproofing or consolidation paste is unadvised.

## 5. PRESERVATION – MOISTURE AND ROOM TEMPERATURE OF THE HOUSE

Excessive temperature and moisture variations within the house may cause changes to the installed wood, namely, fissures on the joints and/or the considerable increase of the parts causing the bending/detachment of the coating.

The parquet must be protected from direct sunlight by means of glass surfaces so as to avoid strong discoloration/oxidation and fissures on the wood.

Special attention must be brought toward the types: Sucupira, Riga Nova, Cumaru, Wenge and Ipê which have a high tendency to longitudinal fissures when exposed to prolonged heat sources (sunlight and high temperature).

The room temperature must range between 20 and 40°C and the Relative Moisture between 40 and 60%. These values are ideal for both the wood and the health of the inhabitants.

Thus the control of these gradients is recommended in order to ensure the balance between moisture and room temperature.

## 6. MAINTENANCE RECOMMENDATIONS

Once installed, the parquet must be protected so as to avoid damage which may diminish its quality or finishing, the following care requires consideration:

- » In case of moving furniture the direct contact with the parquet is to be avoided in order to prevent scratching the varnish;
- » The fall of heavy and pointy objects on the parquet is to be avoided for these may cause dents on the wood;
- » For daily cleaning a floor mop and a BONA Care cleaning product should be used;
- » For more intense cleaning BONA Care and BONA Refresher products should be used;
- » Never use cleaning products containing ammonia, water or other abrasive detergent on wooden floors for these shall damage the finishing and the floor itself.

## RETURNS/COMPLAINTS

Upon the reception of the material, the client must inspect it to ensure its conformity.

Should the product not correspond to the required specifications, a complaint and/or return of the material must be addressed to Madeicentro up to a maximum of 8 days from the issuing of the Shipment Form/Bill of Lading and/or Invoice.

If, upon laying the floorboards any changes to the requested specification are noticed (regarding the visual or dimensional characteristics of the product), it should immediately be rejected and Madeicentro informed toward the verification of it. In case the product has already been laid, Madeicentro will not accept a complaint.

Madeicentro will be held responsible for any deficiency on the wood which occurs during these reception periods, as well as for any deficiency deriving from faulty laying and deficient installation or environmental conditions at the place of use.

The returned material must be defect-free (dents caused by handling at the construction site or transportation; excessive moisture and must be packaged in the same manner as that of the supply;

The complaint must be addressed to Madeicentro in writing claiming the grounds for non-acceptance and the returned material must include the Return Note.

Returns derived from excessive quantity shall not be accepted.

---

In case of doubt or need for additional clarification do not hesitate to contact us. We will be happy to offer all our support.

✓ This document nulls all previous editions.

Avelãs de Caminho, 17 January 2014.

The Management

**GOLDEN PARQUET**  
**THE QUALITY BRAND!**